

# tuscan Elite Engineered Drop Loc Flooring

## Installation Instructions

### Important notice

**The key to long term performance of any floor is the quality of the installation and the immediate and ongoing care and maintenance procedures used on the floor.**

**To help ensure correct installation, care and maintenance for this floor please ensure this guide is fully read and adhered to by your floor installer.**

Tuscan Elite engineered wood floors are suitable for all domestic rooms **EXCLUDING** bathrooms, shower rooms and any rooms that are subject to excessive moisture and or high levels of humidity.

Tuscan Elite engineered flooring is **NOT SUITABLE FOR USE OVER ANY FORM OF UNDER FLOOR HEATING SYSTEM.**

This product does not carry any form of warranty if installed into any form of commercial environment.

### Installer / Owner Responsibilities:

Tuscan Engineered floors are ultimately a product of nature and therefore not perfect. Tuscan wood floors are manufactured in accordance with accepted industry standards, which permit normal grading deficiencies common to real wood flooring. These grading deficiencies may be of a manufacturing or natural type and therefore an extra quantity tolerance of minimum 10% should be allowed for normal board wastage, cutting out and trimming of boards that may have any objectionable elements within them.

This product is intended for use in residential property rooms only (**excluding** wet rooms, bathrooms, areas of high atmospheric humidity in excess of 65% & below ground basements). The intended installation room must have a consistent air humidity level of between 45 – 60% prior to, during, and following installation during ongoing use.

The product is intended for domestic residential use only and does not carry any warranty if installed into any form of commercial environment.

It is the installer's responsibility to carry out the final inspection of the floor to ensure the colour, grade, quality, manufacture and factory finish of the product is acceptable.

Additionally, the inspection of all flooring must be done before installation. Carefully examine the flooring for colour, finish and quality before installing it. The installer must use reasonable selectivity and hold out or cut off pieces with deficiencies, whatever the cause. If the product is deemed not acceptable for any reason, do not install it and contact your supplier immediately.

**NOTE! – Your Tuscan Elite flooring has a protective film applied to its long edges giving protection to the joints from moisture ingress therefore enhancing its performance long term. DO NOT REMOVE THIS FILM from the edges of the boards prior to, or during, installation of the boards.**

**Prior to installation** of any hardwood flooring product, the installer must determine that the job site environment and the sub floor surfaces involved meet, or exceed, all applicable industry European and British standards. Recommendations regarding the construction of the materials used as well as local codes must be followed. These instructions recommend that the construction and sub floor be suitably dry, stiff, of suitable load bearing strength and flat, (as per B.S. 8201: 2011 & B.S. 8204-1: 2003),

**The manufacturer and distributor (being IDS), declines any responsibility for job failure resulting from, or associated with, sub-surface, sub flooring or job-site environmental deficiencies, lack of or incorrect sub floor preparations and installation errors.**

It is important that the installer checks each board for any type of defect. Any minor defects or objectionable elements within individual boards should be dealt with by trimming and or cutting of the board as is normal good installation practice accommodated for by the wastage factor tolerance added to the job quantity.

If the installer has any concerns about the overall quality of the product these concerns must be clarified with their supplier of the product prior to the installation commencing. Claims for any visible defects within boards that have been fitted will not be accepted and are not covered by the associated product warranty.

## 1 - Pre installation Procedures & Checks.

- Calculate the total square meters or square footage of the room(s) and add 10% for cutting and waste.
  - The packs of flooring should be placed in the room in which they are to be fitted **to acclimatize for 48 hours** and should be carefully stacked on suitable level bearers, in their packaging, to allow air to circulate freely around them. The boards should be **stored and laid in a relative room humidity between 45%-60%** and at a room **temperature of between 18°C and 21°C** (65 degrees to 70 degrees Fahrenheit).
  - Wood flooring is a natural product which will mature with age. The boards will change shade over time through exposure to sunlight.
  - All substrates must be structurally sound, flat and suitably dry. **Concrete subfloors must have a moisture content by volume of below 3%** and or a relative humidity **of less than 65% when checked with a hygrometer in accordance with B.S. 8201: 2011 & B.S. 8204-1: 2003.**  
**Wood or wood based sub floors must have a moisture content by volume of 6 - 10%.**
- The sub floor surface should be free of all contaminants, paints, sealers etc and loose material. All potential sources of moisture e.g. walls, drains, damp proof courses, plumbing, refrigerators, washing machines etc. **MUST** be thoroughly checked and rectified if found to have excessive moisture or are leaking.
- Where possible the boards should be installed lengthways towards the main incoming light source and, where possible, down the length of the room.

### If installing onto a new or existing concrete or screed base

- If an new concrete sub floor has been installed checks must be made in accordance with B.S. 8201: 2011 & B.S. 8204-1: 2003 to ensure the moisture content and humidity of the slab is suitable to accept a naturally moisture sensitive wooden flooring. If the installer is not able to correctly assess the moisture condition of the concrete slab / sub floor then they should employ the services of a specialist contractor who can make the correct checks and assessment of the sub floor to determine its moisture condition.

Alternatively **an appropriate liquid damp proof membrane** can be installed to eradicate any risk of moisture or humidity building up beneath the installed flooring that may then cause board movement issues.

- Existing screeds/concrete must also be checked for moisture irrelevant of age or visual condition. This can be carried out using an appropriate moisture meter or hygrometer and readings must conform to B.S. 8201: 2011 and B.S. 8204-1: 2003. If the appropriate checks cannot be made for any reason install an appropriate liquid damp proof membrane as advised above.

If the installer is unable to make the necessary checks or install an appropriate DPM then seek the advice or services of an appropriate professional to do so.

### If installing onto a wooden sub floor

Tuscan Engineered wood flooring can be installed directly over prepared floorboards, chipboard or ply paneled sub floors and any solid flat, sound and suitably dry sub floor. If the existing wooden floorboards are sufficiently flat and sound, the new boards can be laid directly over them. The Elite boards should be laid at a 90° angle to the existing wooden floorboards.

If the new boards are to be laid in the same direction as the old, plywood sheets (minimum 6 mm thickness) should be screwed to cover the existing floor as per BS 8201: 2011, allowing a 15mm perimeter gap for expansion.

If the existing floor is not suitably flat then it must be made flat and level by overlaying with a minimum 6mm thick exterior grade plywood. Loose boards must be secured or the new floor may squeak. **Please note:** Where screws are being used to secure an overlay, care must be taken not to damage pipes or electrical cables beneath.

All wooden or wood based sub floors must be checked for moisture content and the moisture content of the sub floor and or any ply overlays must be between 6 – 10%.

## 2 - Installation Methods

Your Tuscan Elite Engineered flooring can be installed using either a “floating” or full stick down method. Apart from where specified in the following sections most existing unfixed floor coverings, e.g. lino, carpet etc, should be removed prior to installation of your new wood floor. It is very important that the method of installation used is as recommended and all instructions associated with your chosen method are followed accurately as the warranty offered with this product is only valid if the installation instructions following have been correctly followed.

**NOTE! – Your Tuscan Elite flooring has a protective film applied to its long edges giving protection to the joints from moisture ingress therefore enhancing its performance long term. DO NOT REMOVE THIS FILM from the edges of the boards prior to, or during, installation of the boards.**

### A - Floating Floor installation

Minimum Tools required (not supplied) :-

Utility knife	Square edge
Jigsaw or Hand saw	Pencil
Tape measure	Chalk Line
15mm Spacers	Gloves & Goggles for cutting boards.

Before floating installation of the flooring begins ensure all necessary sub floor checks, remedial work actions and preparations have been completed. Install a **foam underlay that incorporates a polythene damp proof membrane on its reverse.** Run the foam underlay in the same direction as the flooring. The underlay should be butted side-by-side with no overlap. Tape seams together with an appropriate vapor joint tape.

Your floor has a “Drop loc” locking profile and is made to be installed as a floating floor without using adhesive other than on the short joints only of the first and last row of boards as advised below.

Leave an open **expansion gap of min 15mm** around the whole perimeter edge of the flooring, (use 15mm distance wedges or spacers), and around any pipes, stairs, columns, doorframes, doorway thresholds and where the flooring meets any fixed object. Where the flooring run exceeds **10 linear meters in width or length** insert in an “in floor” 15mm expansion gap by using an appropriate “T” mould section. The floor must be able to naturally expand so do not install any boards tight to any construction part of the building or adjoining floors.

Rooms with off square areas like for example L-, F-, T-, U- shapes, separate the areas with an expansion joint especially at door thresholds again using an appropriate T moulding profile.

Claims regarding visible defective floor panels must be made prior to installation. Each board should be inspected to ensure that the quality is acceptable. No claims relating to surface defects can be accepted after installation.

The boards in this pack are of mixed lengths and should be laid randomly across the floor to create the best effect. The installer must open and mix /select boards from several packs at a time during installation to ensure a good mix of lengths and colour / shade variance of the overall floor is achieved.

### Installation of the boards.

Measure the width of the room to be fitted and divide the size by the width of the boards to be installed, From this calculate the width of the final row of boards and if the width of this row is less than 50mm cut the width of the first row of boards to an appropriate width size so as to ensure the width of the final row of boards exceeds 50mm.

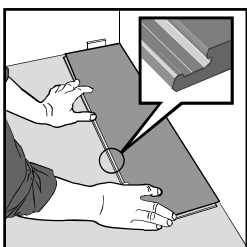

1. First board, first row. Place 15mm expansion gap spacers against the walls or skirting boards at the left hand end, and back long edge, of the first board and position the board end against the wall. The tongue on the back edge of the board should be against the spacers on the facing wall.

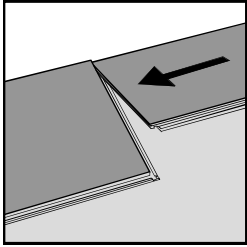

1. Second board, first row. Place a bead of PVA adhesive along the short header joints only of this first row of boards and locate the board end into the short end of the first one.

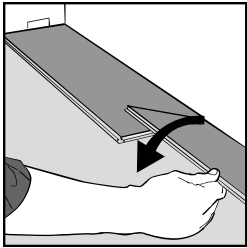

2. Fold the board down with a single action movement to locate the header joint. Continue with the next boards in the same manner.

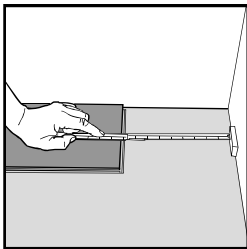

3. At the end of the first row, place a 15mm expansion gap spacer against the right hand wall or skirting board, and measure the length of the last board to fit.

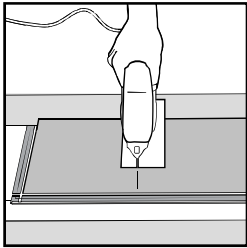

4. Cut the last board to length – hardwood face turned down if using a jig saw or hardwood face upwards if using a hand saw.

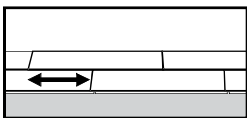
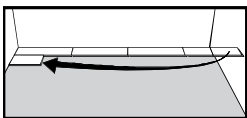

5. Second row. First board, min length 500mm. Use the off cut from the final first row board, (if it is 500mm or longer) to start the second row of boards, Again leave an expansion gap of 15mm against the left hand wall or skirting board. Ensure a minimum 150mm distance between the short end joints of the boards laid in the previous row and the new row being laid.

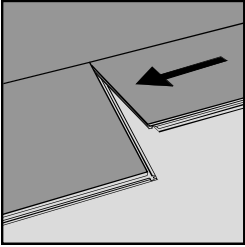

6. Second board second row. Locate the long edge tongue of the board into the long edge groove of the previously laid row. Do not glue these boards simply lay them dry using their drop loc edges.

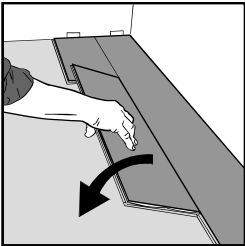

7. Place the board tight to the short end of the previous board and fold down in a single action movement.

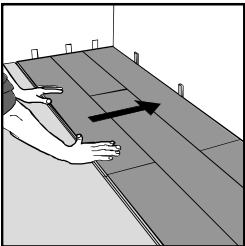

8. After 2-3 rows. Adjust, if needs be the distance between the front wall or skirting and the flooring edge and ensure adequate numbers of 15mm spacers are in place to keep the flooring edge a minimum 15mm away from the wall or skirting at all points along this edge. Continue laying all following rows of boards in this manner until the last row of boards is reached.

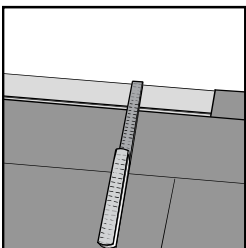

9. Final row. Measure the width of the final row of boards The final row of boards must have a minimum width of 50mm and a minimum 15mm expansion gap must again be left at the edge.
10. Cut the boards to width and locate together as previous boards but for this final row ensure that the short header joints of this final row are glued together using a wood PVA adhesive.

## B – Stick Down Installation using Sika Wood Flooring Adhesives.

### Key Benefits of Sika Wood Floor Bonding Systems



#### Reduction of construction period

**SikaBond®** elastic adhesive systems save time as they are all 1-component products and do not require any priming. They do not contain water so do not cause the wood to swell.



#### Lasting beauty of wood floor

**SikaBond®** elastic adhesive systems do not limit architects and house owners in their choice of different woods. **SikaBond®** bonds them all – as well as ceramic tiles, stone, metals etc. – to basically all different substrates.



#### Maximum walking comfort

**SikaBond®** elastic adhesive systems dampen every step and thus take care of your joints and musculature.



#### Sound radiation reduction (airborne)

Hard wood floor surfaces generate sound with every step. **SikaBond®** elastic adhesive systems reduce sound radiation and reflected airborne noise.



#### Sound radiation reduction (impact)

**SikaBond®** elastic adhesive systems reduce impact sound travelling to properties below by up to 25 decibels.

Sika Limited  
Tel: 01707 394444  
email: technical@uk.sika.com  
www.sika.co.uk



## A Guide to Fitting Solid Wood Floors using SikaBond® Adhesive Systems

### Installation of Solid Wood Floors using SikaBond® Elastic Adhesives

#### POINTS TO CONSIDER

Is your floor dry less than 2% water by weight

Does it need a damp-proof membrane?



Sika® Primer MB is a roller applied damp-proof membrane

#### POINTS TO CONSIDER

Is your floor level and flat (+/- 3mm over 3m straight edge)

Does it need levelling?



Sika® Levelling Compound

#### POINTS TO CONSIDER

Is your floor clean and free of surface contaminants such as floor polish paint etc.

Is it dusty?



#### Bead Application Liquid Battens



**Preparation**  
1 Vacuum substrate properly.  
2 Pierce inner seal on cartridge.  
3 Pre-cut nozzle as shown to give a V shaped profile approximately 10 mm high x 8 mm wide.



**Gunning out**  
1 Holding nozzle at right angle to the substrate, extrude a triangular-shaped bead of adhesive approx. 10 mm high x 8 mm wide at 200 mm centres.

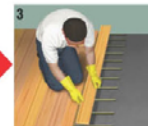

**Placing Wood**  
1 Within 15 hour, place the wood into the SikaBond® adhesive.  
2 Firm to line and level using a mallet and block if required.

#### Full Surface Bonding Application



**Preparation**  
1 Vacuum substrate properly.  
2 Use sufficient SikaBond® adhesive ensuring that wood is placed before surface skin has formed (approx. 30 mins).



**Trowelling out**  
1 Using a notched trowel spread the adhesive evenly at a minimum consumption of 0.7 kg/m<sup>2</sup>.



**Placing Wood**  
1 Place the wood without delay to required line and level, adjusting with a mallet and block if required.

#### Sika®AcouBond-System Application Silent Floor - SikaBond® TS3 and Silent Layer Mat



**Preparation**  
1 Vacuum substrate properly.  
2 Pierce inner seal on cartridge.  
3 Pre-cut nozzle as shown to give a V shaped profile approximately 10 mm high x 8 mm wide.



**Laying Mat and Gunning out**  
1 Roll out Sika® Layer mat so slots are at right angles to the proposed direction of the wood.  
2 Extrude triangular shaped beads of SikaBond® TS3 adhesive approx. 10 mm high x 8 mm wide into all of the cut-out slots.



**Placing Wood**  
1 Place wood within 15 hour to required line and level, adjusting with a mallet and block if required. Ensure a gap of 12-15 mm is maintained around perimeter.

For in depth installation instructions please consult the latest technical data sheet.

## Completing the installation

Once the flooring is installed, whichever method you have used, remove all expansion spacers and cover the expansion gaps by either re-fitting the skirting boards or alternatively, attaching scotia trims **to the skirting** using glue or panel pins.

At doorways a "T" moulding threshold strip should be used to provide the required 15mm expansion gap and to protect the edges of the floor and provide a decorative transition from one floor type to another.

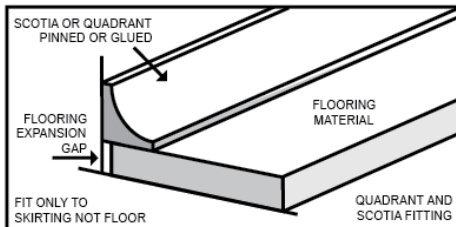

## TUSCAN INSTALLATION ACCESSORIES:

### Tuscan 3 in 1 "T" mould profile

Complementary coloured 3 in 1 multi purpose profile that allows for expansion gaps and provides a smooth transition between different floor coverings within your home.

### Tuscan edge scotia

Conceals the expansion gap between the edge of the floor and the skirting board.

### Sika adhesives

T55 (tubs) and T53 (310ml tubes) are European manufactured adhesives specifically designed for gluing down hardwood flooring.

### Sika MB Primer / DPM

Concrete sub floor 2 part resin based consolidator, primer and Damp Proof Membrane.

### DPM / foam underlay

Basix "Premium Barrier" combination DPM/foam underlay for use when installing the floor as a floating floor.



# CARE AND MAINTENANCE

***Please leave these instructions with the owner of the floor.***

Correct care and maintenance of you Tuscan solid wood floor will help ensure your floor always looks its best and will aid its long term reliability and performance.

**Following installation and for routine care and maintenance please follow these simple instructions:**

## **Tuscan AD48 lacquered or UV Oiled finished floorings**

- Dust, Hoover or brush your floor.
- Clean the floor with “Bona - Wood Floor cleaner” taking care to use the correct type of flat mop and to follow the instructions on the container.

This cleaner is available through your supplier of your Tuscan flooring.

- A Bona – “Wood Floor Cleaning Kit” is also available which includes the Bona cleaner and mop.



## **Ongoing care & maintenance**

- Vacuum or sweep the floor weekly, or more frequently if required. The vacuum head must be brush or soft felt. Do not use a vacuum that has beater bars or a hard metal head.
- A floor swivel head flat mop with replaceable cloth cover is highly recommended to eliminate finer particles of dirt and grit that may build up on the floor.
- Spillages and tracked in dirt should be wiped off the floor immediately.

Periodically, or as is deemed necessary based on dirt build up etc, thoroughly clean your lacquered or UV Oiled floor by using the “Bona –Wood Floor Cleaner”.

**For occasional “refreshing” of your floor surface the following products are available:**



AD48 Lacquered finish : Bona – “Wood Floor Refresher”



UV Oiled Floor : Carl's – “Hardwax Oil Refresher”

**Both these refresher products should be applied using Bona – Refresher applicator pad beige.**



All these maintenance items should be available through you flooring supplier.

### **Things to “do” and be aware of:**

- **DO** - Make use of door mats at all external entrances and over high traffic areas of the floor as this will significantly help to avoid dirt and grit being walked on to the floor.
- **DO** - Use furniture protection pads under all furniture legs and feet as this will avoid damage being caused by the movement of furniture across the floor. Use work station mats at desks, under chairs and in front of any furniture where footfall is continual in a small specific area. This will avoid damage and excessive or accelerated wear from castors, chair feet and specific continual footfall in these areas.
- **DO – Keep the relative humidity within the room between 45–60%** as this will minimise the floors natural tendency to move during the seasons of the year. Small humidity meters can be purchased via many online companies and should be relatively inexpensive and should be used to monitor the humidity levels within the room. Where humidity levels drop below, or rise above the stated 45 – 60% then a humidifier, or dehumidifier, should be used to correct the humidity levels within the room and keep them at the recommended levels until natural levels return between the stated 45 – 60%.
- **DO** - Protect your floor from constant direct sunlight where possible as areas subjected to constant sunlight will age and discolour at an accelerated rate compared to shaded areas of the floor.
- **BE AWARE!** – If mats or rugs are laid on the floor, occasionally reposition them to avoid edge discolouration forming beneath them and at their edges as the flooring ages.
- **BE AWARE!** – That your floor is a natural wood product and as such will show signs of natural movement, such as minor gapping etc, during the initial “settling in” period following installation and changing seasons of the year as it reacts normally to its environmental conditions. minor creaking of boards may also occur during these periods of natural movement due to wood being a hygroscopic material.
- **BE AWARE!** – That shade and colour variance is also a normal feature of wooden flooring and that “blending” of the boards is a normal part of the wood floor installation process to ensure an overall blended acceptable appearance is achieved when fitted.

### **Very important “don’t’s” and things to avoid:**

- **DON’T** - “Wet mop” the flooring, as this will cause excessive expansion of the floor and possible damage to the lacquered and / or oiled surface finishes.
- **DON’T** - Walk on the floor in narrow hard, or stiletto type, heels as this may damage the surface of the flooring.
- **DON’T** – Slide heavy furniture or objects across the floor as this may also damage the surface.
- **DON’T** – Use ammonia based cleaners, acrylic finishes, wax based products, detergents, bleaches, polishes, abrasive soaps or cleaners, or any acidic based cleaners. These type of cleaners can etch or pit the surface of your flooring.
- **AVOID** - Letting pets with claws run across the flooring and always keep pets claws trimmed as animal claws may scratch the surface of the floor.
- **AVOID** – Letting sunlight shine on the floor for long periods of time as this will accelerate ageing of the floor, particularly if your room has large windows or patio doors. The use of curtains & blinds is recommended to reduce the effect of U.V. light ageing the floor.

## Warranty Information

Your Tuscan Elite Engineered flooring comes with a 25 year limited residential use warranty against manufacturing defect.

To maintain the validity of your Tuscan warranty your Tuscan Elite Engineered floor must be installed, cleaned and maintained in accordance with the published installation, care and maintenance details.

Please note that any longer term renovation of your floor involving sanding and sealing will render the original warranty invalid.

### **What to do if you have any problems.**

If there is a problem with your Tuscan flooring, prior to contacting Tuscan /IDS you must have attempted to contact your supplier and/or installer to report the issue with your product and have requested an initial inspection of the products by your supplier and/or installer. Following this, but within 28 days from the date that the defect arose or became apparent, if it is believed that a manufacturing defect is the cause of the problem with the product, you should contact Tuscan/IDS on [info@tuscanflooring.co.uk](mailto:info@tuscanflooring.co.uk). It is likely that the

supplier/installer/IDS will wish to inspect the product and the purchaser must allow reasonable access to the product in order for such inspection to take place. It is strongly recommended that proof of purchase and any associated documentation

(for example, written documentation confirming the sub floor moisture suitability and moisture levels recorded prior to installation of the Product) are kept in a safe place as proof of purchase and any associated documents will be requested before any investigation takes place.

A copy of the associated warranty document stating its terms and conditions is available to download via our Tuscan flooring website – [www.tuscanflooring.co.uk](http://www.tuscanflooring.co.uk)

This warranty is subject to English law and to the exclusive jurisdiction of the English Courts.

**Disclaimer:**

We reserve the right to make amendments to these instructions without prior notification.

E&OE.

V190312